

Ersa i-CON VARIO 2

Kurzanleitung / Short Instructions Guide rapide

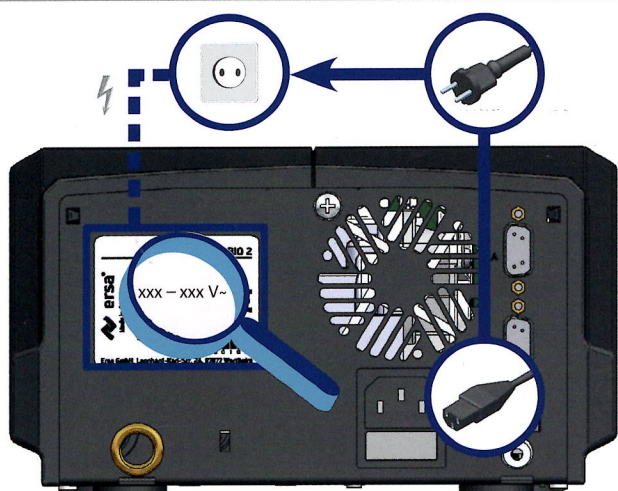

i-TOOL



X-TOOL VARIO



i-TOOL HP



CHIP TOOL VARIO



i-TOOL AIR S



In den Arbeitsmodus gelangen / Get to the working Mode / Atteindre le mode de travail:



Aus / Off / Vide



An / On / Allumés

In den Parametermodus gelangen / Get to the parameter Mode / Atteindre le mode paramétrage:

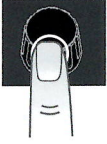

2 sec

In den Konfigurationsmodus gelangen / Get to the configuration Mode / Atteindre le mode de configuration:

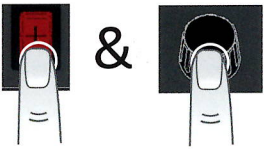

Anschalten / Switch on / Allumer & 2 sec

Die Menünavigation verwenden / Use the navigation menu / Utiliser le menu de navigation:



Vor / Forward / En avant



Zurück / Backward / En arrière

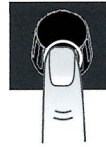

Auswählen / Select / Sélectionner

Einen Wert ändern / Adjust a value / Ajuster une valeur:



Plus / Increase / Plus



Minus / Less / Moins

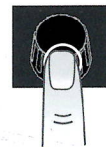

Bestätigen / Confirm / Confirmer

Zwischen Werkzeugen wechseln / Switch tools / Changer d'outil:



Werkzeug 1 / Tool 1 / Outil 1

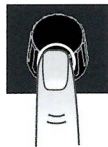

1x



Werkzeug 2 / Tool 2 / Outil 2